

Arai
HELMET®

20
24



Since 1937, Arai is a family company, driven by the same family, with the same mission, through three generations of riders : build the best possible helmet.

Every Arai helmet is inspected by different quality inspectors to ensure that the customer gets a perfect finished product.

In every Arai shell you will find the signature of the craftsman who made it. You may never see it, but it is here!

Their mission were always been the protection and comfort of riders, that's all!

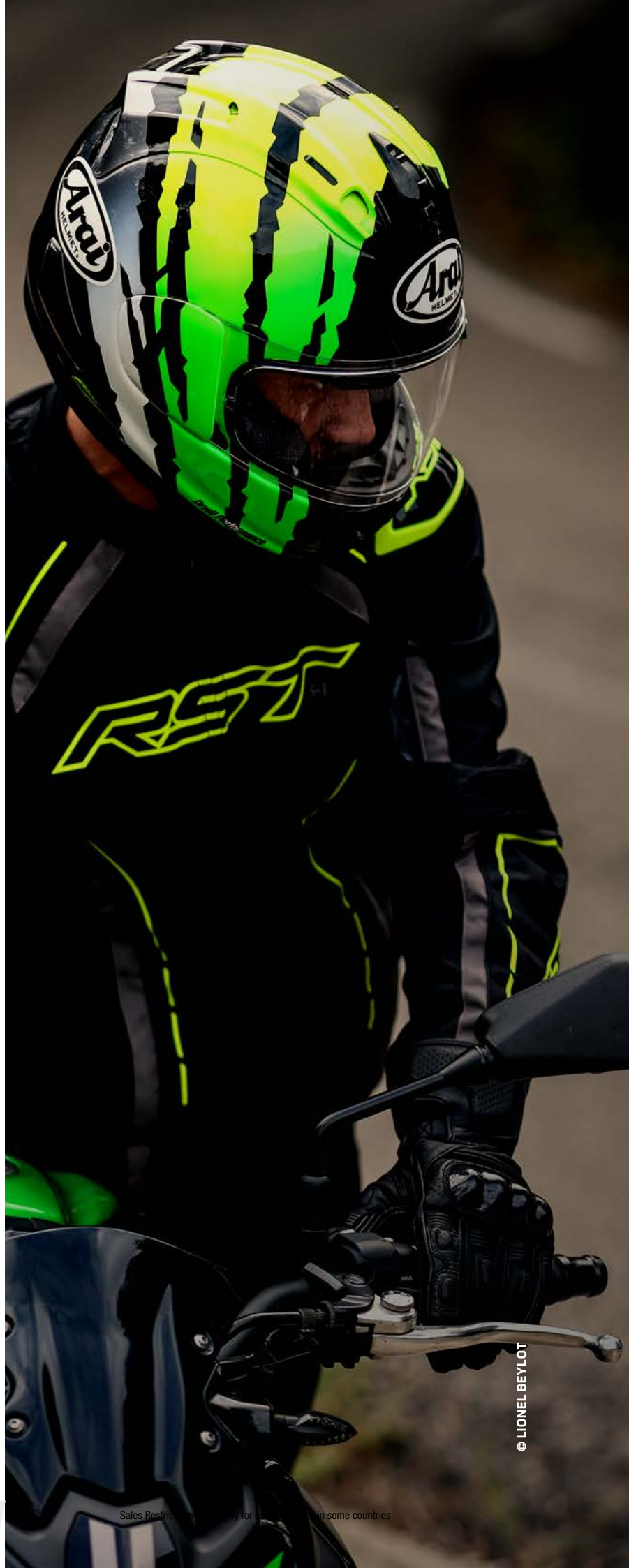

© LIONEL BEYLOT



SUMMARY

02 HOMOLOGATION ECE-2206

FULL FACE

NEW **05** RX-7V EVO FIM 2

06 RX-7V EVO

16 QUANTIC

26 CONCEPT-XE

NEW **32** TOUR-X5

OPEN FACE

NEW **42** SZ-R VAS EVO

48 SPARE PARTS

63 PINLOCK

64 SENA

© LIONEL BEYLOT

ECE R22-06



© JAVI ECHEVARRÍA

Since 2003, the ECE-2205 norm was the motorcycle helmet homologation approval in Europe. After 18 years of validity, it has become obvious that this norm would need an upgrade to fit to the new helmets standards. Indeed, since 2003, the motorcycle helmets have been improved significantly with quick releases, multi-density EPS and so on. On the other hand, some innovations have appeared to be used as sales features such as integrated sun visor or modular helmets for example.

At ARAI, we have always been focused on the most important feature of an helmet: the rider protection. We have always think an homologation is a minimum what a helmet should do and we are always looking for improvements, real world accidents. This is the reason why we have constantly been looking at improving year after year the safety performance of our helmets.

In 2021, the ECE-2205 homologation had "evolve" to ECE-2206 in order to meet new standards and increase the rider's protection. We have been looking for these improvements for 3 generations, and that's how we managed to have the world first helmet passing this norm already in mid-2021. Already 18 years ago, ARAI was the first helmet manufacturer to have an ECE-2205 & SNELL approved helmet (RX-7GP). This shows once again that ARAI's obsession has always been to protect the riders.



© ARAI

WHAT IS GOING TO CHANGE?

This ECE-2206 is a more stringent approval, testing helmets with additional crash-test, new impact points, more diversity of speed and impact surface.

- **NEW IMPACT POINTS:** Addition of 12 impact points, which will increase the overall helmet testing and prevent helmet manufacturers to build helmet focused on very few impact point. We know at ARAI that crashed are unpredictable.

- **ADDITIONS OF SPEED TESTING:** Addition of high and low velocity tests. Kinetic energy goes up in proportion to the speed, which means that the ECE-2206 is more depending on the impact dispersion. On the other hand, the low speed impact is important for the EPS liner, to absorb when the outer shell has not much opportunity to crack and divide the energy, the EPS liner has to absorb most of it.

- **ADDITION OF AN OBLIQUE IMPACT TEST:** This test is the first one that is considering what we always have been truly believed in the most important feature of an helmet performance, we refer to "Glancing Off". As soon as the helmet hits the anvil, the direction is changed from vertical to horizontal. By having a rounder and smoother shell, the helmet will bounce off, this is one of the reasons why ARAI has been the first one to pass this new regulation, we have always been focused on rider safety.



WHEN WILL THAT CHANGE?

Due to the pandemic, the activation of that new homologation became a real challenge for several helmet manufacturers. But there is no official announcement on the change of the initial plan which is:

- **From July 2022** it is no longer possible to approve or extend according to the ECE-2205 series.

- **From July 2023** it is no longer allowed to use the approval numbers from the ECE-2205 series.

- **From January 2024** it is prohibited to sell ECE-2205 series products by contracting parties. Sooner or later, all the rider gear industry will have to adapt to this new standard. ARAI is once again demonstrating its capacity of manufacturing the best helmets in the world by having homologated the first ECE-2206 approved helmet in 2021, available on the market 6 month ahead of any other brand. By 2022, ARAI will be able to provide 2 models homologated with the plan to have the full range ECE-2206 by 2024.

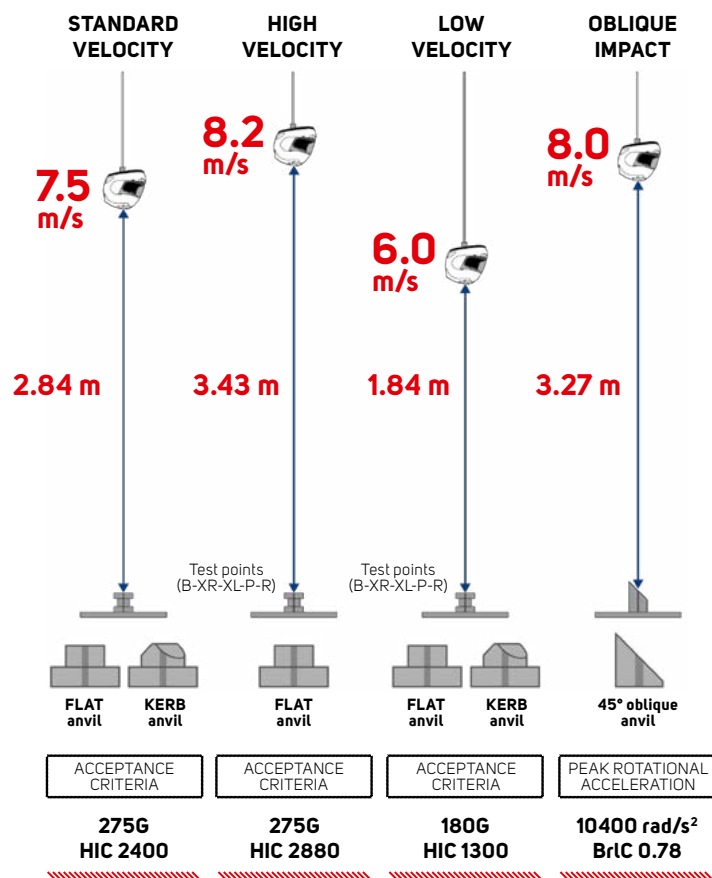
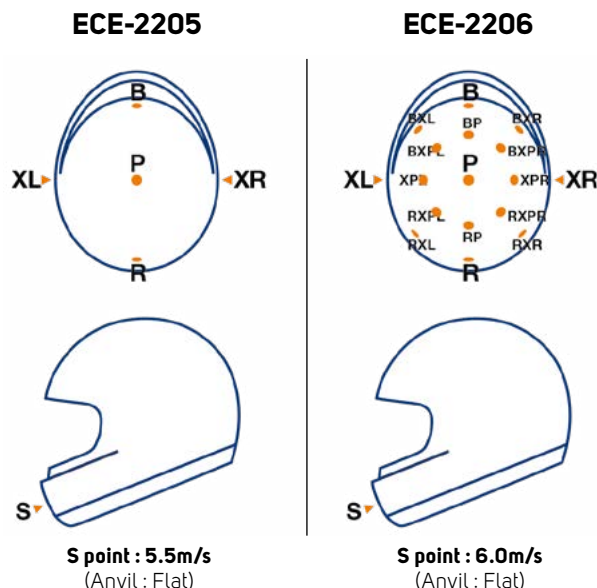

ECE R22-06



You will find this logo indicating ECE 22-06 homologated helmets in the catalogue



Full face helmets



RX-7V EVO FIM 2



1119 CHF



	XS	S	M	L	XL	2XL	3XL
FIM 2	8009201001	8009201002	8009201003	8009201004	8009201005	8009201006	8009201007

ARAI presents the best helmet made for competition.

The new RX-7V RACING is going a step forward thanks to a new technologic feature: the Aerodynamic assist.

This new aerodynamic spoiler homologated FIM facilitates the air flow from the back of the helmet and the racing suit bump:

- Improvement of the Air Flow
- Faster is the speed, more the air-effect is perceived
- New design for the rear ventilation

OTHER FEATURES :

- FIM homologation: ARAI is one of the only brand able to provide the FIM homologated helmet to any riders.
- This homologation is not fundamentally changing the helmet from a RX-7V standard. One of the few difference is the friction ratio between the two shells to allow a better head rotation within the helmet.
- The size range is from the XS to 3XL, (the exact same sizes as the regular RX-7V)

ARAI awarded from the FIM gold medal

ARAI is the first brand that has been awarded from the FIM as a security manufacturer for the riders.

This medal has been given to Michio ARAI for his "achievement in contributions to the safety of many riders and numerous advancements to motorcycle sports over many years"



Made for competition

2D visor with tear-off post



Antibacterial liner material



Emergency Release System (ERS)

SIZE CHART

XS	53-54cm
S	55-56 cm
M	57-58 cm
L	59 cm *59-60
XL	60-61 cm *61-62
2 XL	62-63 cm *63-64
3 XL	64-65 cm *65-66

■ Full face helmets



RX-7V EVO



© LIONEL BEYLOT



OUTER SHELL : PB SNC²

Super Fibre and other special synthetic fibres, with superb tensile strength and flexibility characteristics, developed for F-1 helmet, are assembled and bonded by Arai experts, to create stronger and lighter shell.



DIFFUSER TYPE 12

20mm longer, compared to the previous model, their efficiency is increased by 19%. New Air Wing to improve stability. Adjustable : 3 positions; closed, half open and open but also help to improve sealing that decreases wind noise and water intrusion.



ECO PURE LINER

The fully removable interior liner system has been improved with new Eco Pure antibacterial material, which helps maintain neutral acidity levels close to human skin. Softer and deeper new liner for great comfort. Adjustable temple padding that allows to customize fit.

STRONGER SHELL ADVANCED BY THE LATEST TECHNOLOGIES

From extreme ventilation to unmatched comfort, among numerous other advances you expect in our RX-7V EVO model.



AIR CHANNEL

Enhanced air exhaust from the eye port area, pulled through dedicated air channel to side cowl-6, improving efficiency and reducing noise.

FULL SUPPORT INTERIOR

FCS Cheek pad with ear pocket recess for speakers and 5mm peel away layer for added room if needed. Larger space in mouth area for a more open feeling. New emergency release tab positioned at the end of the release strap for easier access by rescue staff. Improved comfort performance with better fitting while being easier to put on and off.

CHIN COVER

The curtain simultaneously blocks air intrusion from turbulent air below and increases negative pressure to enhance the inner air extraction and reduce noise.



IC DUCT5

The new IC Duct5 provides 11% more airflow than the previous Delta Duct5. The new bigger switch makes opening and closing easier. The new IC duct-5 has three positions; closed, half open and fully open to adjust the airflow and prevent water intrusion when fully closed.



VAS V MV SHIELD

VAS MAX Vision shield, very shock resistant, is provided in clear version for better visibility in all seasons. Comes standard with Clear anti-fog Pinlock insert to be installed as needed.

Full face helmets



RX-7V EVO



Years of experience for the ultimate helmet!

The RX-7V EVO represents the summit of Arai's knowledge, experience and knowhow in helmet technology. With a completely new PB-SNC² outer shell, the revolutionary VAS (Variable Axis System) visor system and a significantly increased smoother area around the temples, the RX-7V offers the new benchmark in the premium helmet segment.

- PB SNC2 Shell: Super Fibre and other special synthetic fibres, with superb tensile strength and flexibility characteristics, developed by ARAI.
- Diffuser Type 12: New Type 12 diffusers are 20mm longer and straightened for improved aerodynamics, working together with the Air Wing to improve stability. Compared to the previous Type 10 diffusers, the efficiency of the intake scoops of the new Type 12 diffusers has increased by 19%. The new air intake vents not only have more adjustability with three positions; closed, half open and fully open but also help to improve sealing that decreases wind noise and water intrusion.
- Eco Pure Liner: The fully removable interior liner system has been improved with new Eco Pure material, which helps maintain neutral acidity levels close to human skin and antibacterial consumption.
- VAS V MV Shield: VAS MAX Vision shield is standard to provide better visibility in all seasons and for all types of riding. Comes standard with Clear anti-fog Pinlock insert to be installed as needed.
- Washable interior
- Double-D ring device
- 5-year limited warranty

* WARNING* The RX-7V EVO model have an extra shell size, the sizing chart (cm) are shifted one size from the L size chart

SIZE CHART

XS	53-54cm
S	55-56 cm
M	57-58 cm
L	59 cm *59-60
XL	60-61 cm *61-62
2 XL	62-63 cm *63-64
3 XL	64-65 cm *65-66

Sales Restrictions may apply for certain brands in some countries

Full face helmets



1199 CHF



	XS	S	M	L	XL
SCHWANTZ 30	8009090001	8009090002	8009090003	8009090004	8009090005

1199 CHF



	XS	S	M	L	XL
MAVERICK 2023	8008900001	8008900002	8008900003	8008900004	8008900005

1199 CHF



	XS	S	M	L	XL
OGURA 2023	8008901001	8008901002	8008901003	8008901004	8008901005

Full face helmets



1199 CHF



	XS	S	M	L	XL
BLADE red	8009091001	8009091002	8009091003	8009091004	8009091005

1199 CHF



	XS	S	M	L	XL
BLADE yellow	8009091006	8009091007	8009091008	8009091009	8009091010

1199 CHF



	XS	S	M	L	XL
MAVERICK STARS	8007786001	8007786002	8007786003	8007786004	8007786005

Full face helmets



1199 CHF



	XS	S	M	L	XL
SAMURAI	8007834001	8007834002	8007834003	8007834004	8007834005

1199 CHF



	XS	S	M	L	XL
MWC	8007835001	8007835002	8007835003	8007835004	8007835005

1199 CHF



	XS	S	M	L	XL
JR 65 red	8007836001	8007836002	8007836003	8007836004	8007836005

Full face helmets



1199 CHF



	XS	S	M	L	XL
JR 65 green	8007836006	8007836007	8007836008	8007836009	8007836010

1199 CHF



	XS	S	M	L	XL
SCHWANTZ DESIGN	8006694001	8006694002	8006694003	8006694004	8006694005

1199 CHF



	XS	S	M	L	XL
PEDROSA SPIRIT GOLD	8006689006	8006689007	8006689008	8006689009	8006689010

Full face helmets



1199 CHF



	XS	S	M	L	XL
HAYDEN RESET	8007051001	8007051002	8007051003	8007051004	8007051005

1199 CHF



	XS	S	M	L	XL
HAGA GP	8007050001	8007050002	8007050003	8007050004	8007050005

1199 CHF



	XS	S	M	L	XL
NAKAGAMI GP2	8006686001	8006686002	8006686003	8006686004	8006686005

Full face helmets



1199 CHF



	XS	S	M	L	XL
TATSUKI	8006687001	8006687002	8006687003	8006687004	8006687005

1199 CHF



	XS	S	M	L	XL
KIYONARI TRICO	8007837001	8007837002	8007837003	8007837004	8007837005

999 CHF



	XS	S	M	L	XL	2XL	3XL
DIAMOND white	8006684001	8006684002	8006684003	8006684004	8006684005	8006684006	8006684007

Full face helmets



999 CHF



	XS	S	M	L	XL	2XL	3XL
Diamond Black	8006684008	8006684009	8006684010	8006684011	8006684012	8006684013	8006684014

999 CHF



	XS	S	M	L	XL	2XL	3XL
Frost Black	8006685001	8006685002	8006685003	8006685004	8006685005	8006685006	8006685007

■ Full face helmets



QUANTIC



© LIONEL BEYLOT

Full face helmets

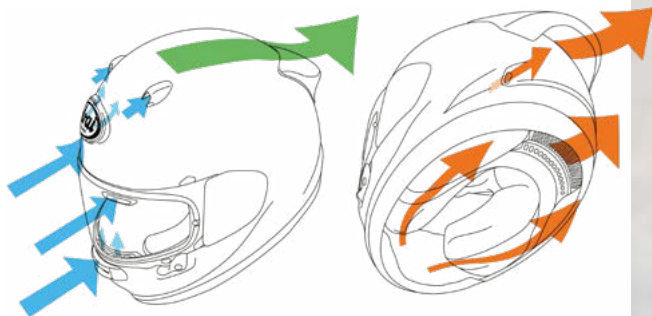

VENTILATION

Comprehensive and controllable ventilation is based around 12 ventilation ports: 6 intake, 6 exhaust. The 3D Arai logo feeds cooling air into two central intake points and works well at low speed, alongside dual F1-derived tear duct top intakes, twin brow vents and 2-position sliding air-scoop, filtered chin vent. Hot air is efficiently extracted via the 3-way one-piece rear exhaust/ spoiler, twin flush-fit side exhausts (with foam dams to reduce noise) and neck exhaust.



PB E-CLC OUTER SHELL

PB e-CLC (Peripherally Belted e-Complex Laminate Construction).

The PB e-CLC outer shell design outlines a stylish, organic shape and uses a Peripherally Belted e-Complex Laminate Construction for lightweight strength; it's designed to glance off and spread impact forces. New materials have been used to substitute the AR-mat as middle layer, resulting in a substantial weight reduction while maintaining the same strength as the PB-cLc construction.



3D ARAI LOGO DUCT

Immediately noticeable, the new 3D Arai logo duct (just 3.5mm in depth) feeds two central 10mm intake ports. This is a first in an Arai, and entirely due to PB e-CLC's strength and the shell construction. It also works very well at low speed and with an upright riding position; at just 50km/h it's channelling an extra 40% airflow, at 120km/h 7%. If the rider can't see the lever and the logo is in its normal place, the duct is open. The Arai logo duct is designed to breakaway in the event of an impact.



© LIONEL BEYLOT



REPLACEABLE INTERIOR

The complete interior may be easily removed. All parts (replaceable or not) can be cleaned with lukewarm water and mild soap. Rinse well after cleaning and never dry in direct sunlight or near a heat source. Interior parts in different size thickness are available for a custom fit for every rider.



REAR EXHAUST/SPOILER

The one-piece rear exhaust/spoiler, operated by a 3-way switch, is inspired by the DX-2 of the RX-7V Racing, but redesigned for touring use – however, it was tested up to 300km/h at Suzuka. It is fed by 3 ports in the shell. As part of the Quantic's comprehensive ventilation system it efficiently draws air but also smooths airflow over (and from the side) of the helmet, improving stability and reducing buffeting. The result is much less rider fatigue. It's designed to crush or break away upon impact, therefore having no impact on protective performance.



AIR-SCOOP CHIN VENT

Also new is the 3-position (open, midway and closed) sliding air-scoop chin vent which flows a larger intake volume of air and has a replaceable filter. The actuating mechanism is thicker and easy to use with gloves.

Full face helmets



QUANTIC



The new Arai Quantic – as the mathematical definition describes – draws together in harmony the qualities and design elements found in helmets throughout the Arai range, while adding fresh features all of its own.

The Quantic offers a new choice for riders that want the very best helmet – in terms of protection, performance, comfort and ease of wear – without compromise. Using the aerodynamic and protective abilities of Arai's full-race helmets, and all the experience and know-how earned over millions of road kilometers, the Quantic joins race and road specification together in sleek, beautiful form.

- Aimed at the sports-touring rider who wants dynamic, race-derived performance
- With luxurious comfort and features suitable for long riding days
- E-Complex Laminate Construction (e-cLc) outer shell with VAS
- Glancing Off concept: increases the ability of glancing off objects, without transmitting shock energy to the rider
- New 3D Arai Ventilation logo
- New Dual 'tear duct' top intake vents
- Two-position sliding chin vent
- One-piece rear exhaust/spoiler
- New Dedicated shell area to accommodate communication device
- ECE R22-06 approved

SIZE CHART

XS	53-54cm
S	55-56 cm
M	57-58 cm
L	59-60 cm
XL	61-62 cm

© LIONEL BEYLOT

Full face helmets



849 CHF



	XS	S	M	L	XL
MARK red	8009093001	8009093002	8009093003	8009093004	8009093005

849 CHF



	XS	S	M	L	XL
MARK yellow	8009093006	8009093007	8009093008	8009093009	8009093010

849 CHF



	XS	S	M	L	XL
ABSTRACT red	8009094001	8009094002	8009094003	8009094004	8009094005

Full face helmets



849 CHF



	XS	S	M	L	XL
ABSTRACT blue	8009094006	8009094007	8009094008	8009094009	8009094010

849 CHF



	XS	S	M	L	XL
MOSAIC black	8009095001	8009095002	8009095003	8009095004	8009095005

849 CHF



	XS	S	M	L	XL
ROBOTIK blue	8007838001	8007838002	8007838003	8007838004	8007838005

Full face helmets



849 CHF



	XS	S	M	L	XL
ROBOTIK red	8007838006	8007838007	8007838008	8007838009	8007838010



849 CHF

	XS	S	M	L	XL
ROBOTIK black	8007838011	8007838012	8007838013	8007838014	8007838015



849 CHF

	XS	S	M	L	XL
SPACE blue	8007839001	8007839002	8007839003	8007839004	8007839005

Full face helmets



849 CHF



	XS	S	M	L	XL
SPACE red	8007839006	8007839007	8007839008	8007839009	8007839010

849 CHF



	XS	S	M	L	XL
DARK CITIZEN	8007840001	8007840002	8007840003	8007840004	8007840005

849 CHF



	XS	S	M	L	XL
PODIUM	8007841001	8007841002	8007841003	8007841004	8007841005



Full face helmets



749 CHF



	XS	S	M	L	XL
Diamond white	8000432001	8000432005	8000432006	8000432007	8000432008

749 CHF



	XS	S	M	L	XL
Diamond Black	8000432010	8000432011	8000432012	8000432002	8000432003

749 CHF



	XS	S	M	L	XL
Frost Black	8000433001	8000433002	8000433003	8000433004	8000433005

Full face helmets



749 CHF



	XS	S	M	L	XL
Modern Grey	8000434001	8000434002	8000434003	8000434004	8000434005



© LIONEL BEYLOT

Suggested retail prices, all taxes included - updated online on

mybihr.com

Bihr 
Powering your passion

25

■ Full face helmets



CONCEPT-XE



© LIONEL BEYLOT

Full face helmets



SPEAKER POCKET

Build in communication systems are popular, but the problem is often that the room for a speaker is limited or just not present, causing unpleasant pressure points. The Renegade V is equipped with special speaker pockets, offering room for mounting speakers without effecting comfort or fit. (Speaker not included).



OUTER SHELL : PB E-CLC

The Concept-XE's outer shell uses a Peripherally Belted e-Complex Laminate Construction (PB e-CLC) for lightweight strength; it's designed to glance off and spread impact forces. New materials have been used to substitute the AR-mat as middle layer, resulting in a substantial weight reduction while maintaining the same strength as the PB-e-CLC construction.



PEEL AWAY PADS

5mm thick removable foam layer on the ear cups/cheek pads and temple pads. Offering more room if desired without the need to purchase an optional headliner or new pads/ear cups.



ANTIBACTERIAL LINER

The fully removable antibacterial interior liner system has been improved, helps maintain neutral acidity levels close to human skin. Softer, deeper and more comfortable fit the new liner also has adjustable temple padding that allows for a customized fit.

VARIABLE AXIS SYSTEM (VAS)

With VAS, the visor mounting position is lowered, yielding an average of an additional 24mm across both temple areas, in pursuit of the ideal smoother shape that increases the ability of glancing off energy.



NEW VENTILATION SYSTEM

The Concept-XE features an exclusive ventilation system that is unique to this model. It is instantly recognizable by the large intake duct (reclodable) on the front part of the helmet. The large inlet allows generous amounts of cool, fresh air to enter the helmet, assisted by the large single frame rear duct. The exhaust function of the large front duct keeps working when the intake is closed. The two small exhaust vents on the back of the helmet help to quickly dispose hot, warm air from the helmets interior.

FACIAL CONTOUR SYSTEM

To offer an even better snug fit and enhancing the comfort to the lower jaw, the Facial Contour System (FCS) works with a foam spring support in the cheek pad that compresses and rebounds

Full face helmets



CONCEPT-XE



© LIONEL BEYLOT

A cutting-edge technology that look vintage !

While a homage to the classic style of the 1980s, the Concept-XE is equipped with all the latest protection and comfort. A simple and sophisticated form that is not categorized by any genre. In addition to Arai's first inner ventilation system, it features a full system interior which has almost the same materials as racing models. A "Neo Classic" helmet that is not only for classic bikes and cruisers but also compatible with the latest motorcycles.

- PB-e cLc outer shell, constructed of Arai's original super fiber and a newly developed resin
- New Arai vent system : three exhaust holes are provided on top so that air passes through the air channel in the liner and is exhausted efficiently through the slit at the back of the head by negative pressure caused when riding. The highly efficient ventilation is realized while maintaining a simple and clean surface
- Glancing Off concept: increases the ability of glancing off objects, without transmitting shock energy to the rider
- VAS MAX Vision visor, enhanced visibility in all seasons and for all types of riding, Pinlock Ready
- VAS system : compact visor with Variable Axis System, better protection in the temple areas, without compromise on visual field
- FCS Facial Contour System : perfect fit for every kind of face
- Multi-Density EPS inner liner
- Anti-bacteria, anti-fouling and deodorant properties Ecopure interior. Fully removable and washable
- "Peel away" 5mm thick removable foam layer. Offering more space if desired without the need to purchase an optional part
- Emergency Release System (ERS)
- Hand crafted
- The Concept-XE has widely outperforming all standard tests : Main Arai goal is making the safest helmets in the world
- 5-year limited warranty
- Suitable with PSS (Pro Shade System) visor : the all-weather solution against fogging, misting and sun-glare - Available separately

SIZE CHART

XS	53-54cm
S	55-56 cm
M	57-58 cm
L	59-60 cm
XL	61-62 cm

Full face helmets



869 CHF



	XS	S	M	L	XL
TEMU blue	8009092001	8009092002	8009092003	8009092004	8009092005

869 CHF



	XS	S	M	L	XL
TEMU green	8009092006	8009092007	8009092008	8009092009	8009092010

869 CHF



	XS	S	M	L	XL
REACT 1 brown	8007829001	8007829002	8007829003	8007829004	8007829005

Full face helmets



869 CHF



	XS	S	M	L	XL
REACT 2 blue	8007829007	8007829008	8007829009	8007829010	8007829011



869 CHF

	XS	S	M	L	XL
OVERLAND	8007830001	8007830002	8007830003	8007830004	8007830005

Full face helmets



739 CHF



	XS	S	M	L	XL
Frost black	8007828001	8007828002	8007828003	8007828004	8007828005

739 CHF



	XS	S	M	L	XL
Modern grey	8007828007	8007828008	8007828009	8007828010	8007828011

■ Full face helmets

NEW
2024



TOUR-X5



© LIONEL BEYLOT

SHARPER LOOKING AND MORE COMFORTABLE.



TOUR-X5 PEAK

The all-new peak is designed for more effective ventilation, increased high speed flow-through performance, greater range of adjustability for blocking the sun, and is more resistant to buffeting, all of which leads to an overall more comfortable riding experience.



VAS-A VISOR SYSTEM

This new visor system allows for easier and faster visor swaps. The visor can be attached or removed without the need for any tools. The peak utilizes only one screw on each side for removal/installation.



TOUR-X5 MOUTH SHUTTER

The opening area for the TOUR-X5 mouth-shutter doubled compared to the TOUR-X4. Thanks to the evolution in shell strength from the previous generation, the aperture could be made larger, and the mouth shutter could be made to flow more fresh air without the need for the mesh vents as seen on its predecessors.



SPEAKER POCKET

Speakers can be installed directly to the provided hook & loop panel without the need to remove the cheek pad covers. Both ear pockets are deep and wide, designed to accommodate even the thickest speakers with plenty of room to position them to increase comfort.



AR SPOILER

Set in a position that makes it ideal for adventure riding, the AR spoiler contributes to reducing fatigue from turbulent air throughout long rides, and works to draw out hot air from the crown area.

ODOR-RESISTANT INTERIOR

The TOUR-X5 utilizes an interior liner that has the same level of acidity as bare skin and has odor resistant and stain-resistant properties. The headliner is equipped with a removable foam layer on both the left and right sides, allowing you to remove 5mm of foam from each side if desired for micro-fitting.



FRONT LOGO DUCT

The effectiveness of conventional forehead vents could be limited by the rider's position, but with the front logo duct, airflow is unaffected by changes in riding position. Thanks to advances in shell technology, we can add holes in the forehead area for this vent without compromising the helmet's ability to protect.



VAS-A MAX-VISION VISOR

The new max-vision visor preserves the wide field-of-view and high level of visibility expected of an Tour-X5 model. The Pinlock insert for this model has advanced to be effective at resisting fogging, even in extreme conditions, across the entire field of view.

Full face helmets



TOUR-X5



© LIONEL BEYLOT

Adventure, on-road, or off-road: the TOUR-X5 has a ventilation style that consistently exudes a sharp appearance. Enhancing the field-of-view from the previous generation, the TOUR-X5 visor is even wider than the TOUR-X4 visor. Many features on the TOUR-X5 have evolved to provide an even more comfortable riding experience.

The forehead area of the shell is reinforced by a Super Fiber belt which is similar to the way in which bands strengthen a barrel. Not only that, but the PB-cLc² shell is meticulously assembled using an assortment of materials so that it can be not only strong, but also lightweight. The shells are handmade by our experienced shell experts, carefully arranging each and every piece of material to create an Arai shell.

The amount of energy that any helmet can absorb is inherently limited and we believe in a crash the only option is to have the helmet glance in a way that directs the impact energy away from the inside of the helmet.

The shell of the TOUR-X5 is designed to be round so that it can more easily 'glance off' impact energy in an actual crash.

When faced with the rare event of an impact, the VAS-A visor system of the TOUR-X5 has been lowered to further improve 'glancing off' ability. So that our helmet may 'glance off' more impacts, even if it is just a slight improvement, the temporal region of the TOUR-X5 has been smoothed out more than on its predecessor. This change further realizes the ideal form for 'glancing off'.

SIZE CHART

XS	53-54cm
S	55-56 cm
M	57-58 cm
L	59-60 cm
XL	61-62 cm

Full face helmets



1099 CHF



ECE R22-06
Arai



	XS	S	M	L	XL
AFRICA TWIN blue	8009096001	8009096002	8009096003	8009096004	8009096005

1099 CHF



ECE R22-06
Arai



	XS	S	M	L	XL
AFRICA TWIN red	8009096006	8009096007	8009096008	8009096009	8009096010

1079 CHF



ECE R22-06
Arai



	XS	S	M	L	XL
DISCOVERY blue	8008933001	8008933002	8008933003	8008933004	8008933005

Full face helmets



1079 CHF



ECE R22-06
Arai



	XS	S	M	L	XL
DISCOVERY white	8008933006	8008933007	8008933008	8008933009	8008933010

ECE R22-06
Arai



1079 CHF



	XS	S	M	L	XL
DISCOVERY red	8008933011	8008933012	8008933013	8008933014	8008933015

ECE R22-06
Arai



1079 CHF



	XS	S	M	L	XL
DISCOVERY orange	8008933021	8008933022	8008933023	8008933024	8008933025

Full face helmets



1079 CHF



	XS	S	M	L	XL
DISCOVERY black	8008933016	8008933017	8008933018	8008933019	8008933020



1079 CHF



	XS	S	M	L	XL
TRAIL blue	8009097001	8009097002	8009097003	8009097004	8009097005



1079 CHF



	XS	S	M	L	XL
TRAIL yellow	8009097011	8009097012	8009097013	8009097014	8009097015

Full face helmets



1079 CHF



ECE R22-06
Arai



	XS	S	M	L	XL
COSMIC red	8008934001	8008934002	8008934003	8008934004	8008934005

1079 CHF



ECE R22-06
Arai



	XS	S	M	L	XL
COSMIC neon yellow	8008934011	8008934012	8008934013	8008934014	8008934015

1079 CHF



ECE R22-06
Arai



	XS	S	M	L	XL
COSMIC blue	8008934006	8008934007	8008934008	8008934009	8008934010

Full face helmets



999 CHF



	XS	S	M	L	XL
DIAMOND white	8008929001	8008929002	8008929003	8008929004	8008929005

999 CHF



	XS	S	M	L	XL
DIAMOND black	8008929006	8008929007	8008929008	8008929009	8008929010

999 CHF



	XS	S	M	L	XL
Frost Black	8008915011	8008915012	8008915013	8008915014	8008915015

Full face helmets

ECE R22-06



999 CHF



	XS	S	M	L	XL
ADVENTURE grey	8008932001	8008932002	8008932003	8008932004	8008932005



© LIONEL BEYLOT

Suggested retail prices, all taxes included - updated online on

mybihr.com

Bihr 
Powering your passion

41

■ Open face helmets



SZ-R VAS EVO

NEW
2024



© LIONEL BEYLOT

Open face helmets



829 CHF



	XS	S	M	L	XL
Diamond white	8009034001	8009034002	8009034003	8009034004	8009034005

For riding professionals, long-range tourers and urban commuters alike, the Arai SZ-R VAS EVO has become the choice of premium open-face helmets. It's easy to see why. The combination of protection, light weight, comfort and open, all-round visibility make the SZ-R VAS EVO a unique, and special, proposition.

2023 sees the SZ-R VAS gain ECE R22-06 approval and EVO status, without significant changes. Arai's Priority for Protection, the core design philosophy of producing rounder, smoother and stronger outer shells to improve 'Glancing Off' performance, is key in this attainment, as is the rigorous in-house criteria that all Arai helmets must satisfy.

As with each and every Arai, it's the sum of the details coming together to produce an even greater result than their sum that makes the SZ-R VAS EVO the benchmark open face helmet it is. The Variable Axis System (VAS) design effectively lowers the visor pivot point by using a dual pivot assembly. This allows the shell to be smoother around the critical temple area.

The PB-CLC2 outer shell itself is manufactured using a special Z compound of various resins, and balanced by a lightweight inner liner, that lowers the centre of gravity.

Comfort in the SZ-R VAS EVO is supreme over long distances, thanks to interior contact points that cradle the rider's head evenly. The interior is also fully adjustable and designed for the use of glasses and speakers. Ventilation is taken care of by the same diffuser technology as used by the flagship racing-spec RX-7V EVO, with an added aero stabiliser.

The SZ-R VAS EVO comes with a Pinlock insert included.

SIZE CHART

XS	53-54cm
S	55-56 cm
M	57-58 cm
L	59-60 cm
XL	61-62 cm

Open face helmets



829 CHF



	XS	S	M	L	XL
Diamond black	8009034006	8009034007	8009034008	8009034009	8009034010

829 CHF



	XS	S	M	L	XL
Matt green	8009013016	8009013017	8009013018	8009013019	8009013020

829 CHF



	XS	S	M	L	XL
Matt blue	8009013021	8009013022	8009013023	8009013024	8009013025

Open face helmets



829 CHF



	XS	S	M	L	XL
Modern Grey	8009045001	8009045002	8009045003	8009045004	8009045005

829 CHF



	XS	S	M	L	XL
Frost Gun Metallic	8009049001	8009049002	8009049003	8009049004	8009049005

829 CHF



	XS	S	M	L	XL
Frost white	8009013006	8009013007	8009013008	8009013009	8009013010

■ Open face helmets



829 CHF



	XS	S	M	L	XL
Frost black	8009013011	8009013012	8009013013	8009013014	8009013015



© LIONEL BEYLOT

Suggested retail prices, all taxes included - updated online on

mybihr.com

Bihr 
Powering your passion

47

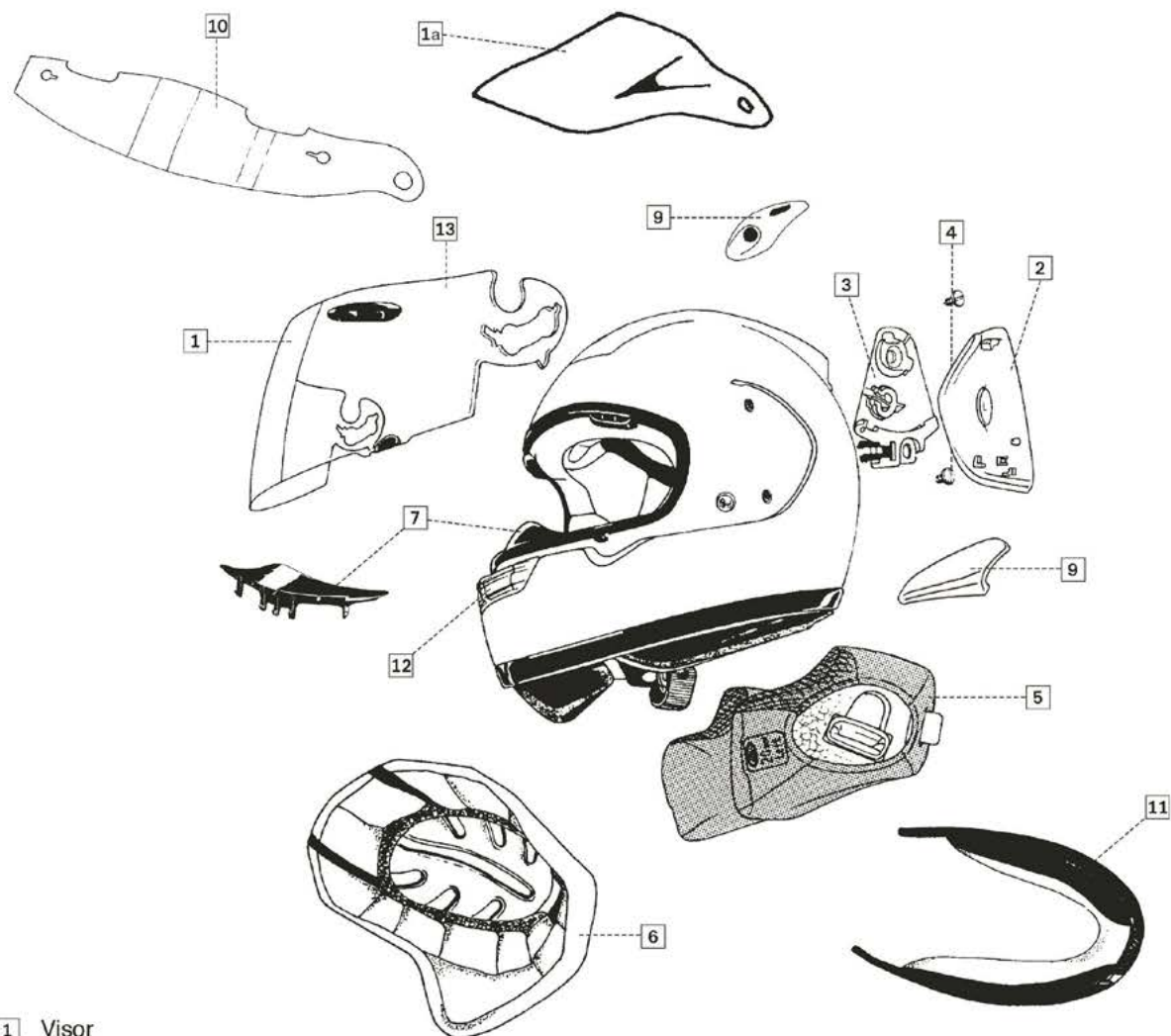

- 1** Visor
- 1a** Peak
- 2** Holder set
- 3** Baseplate
- 4** Screw set
- 5** Cheekpad/Earcup
- 6** Interior
- 7** Nose/Breath deflector
- 9** Ventilation ducts
- 10** Tear-offs
- 11** Neck pad
- 12** Chinvents
- 13** Browvents

20 CHF

8002833001

Spare parts

Shields and compatible helmets mapping table



All Arai spare parts
are available on:
mybihr.com



■ Spare parts



VAS-V shield Max Vision



89 CHF

Light Smoke w/ Brow Vents 8003117001



89 CHF

Clear w/ Brow Vents 8003117002



89 CHF

Dark Smoke w/ Brow Vents 8003117003



159 CHF

Silver 8007850001



159 CHF

Red 8007850002



159 CHF

Blue 8007850003



159 CHF

Green 8007850004

VAS-V Shield 2D



79 CHF

Clear 8003116001



85 CHF

Dark Smoke 8003116002



85 CHF

Light Smoke 8003116003

VAS-V dual shield



165 CHF

Incolore

8003118001



165 CHF

Light smoke

8003118002

VAS-V PSS ready shield



89 CHF

Clear

8003098001

VAS-V PSS Kit



129 CHF

Clear Shield + Sunvisor +
Mecanism

8006303001

VAS-V PSS Sunvisor



55 CHF

Tinted

8006303002

VAS-V Pro Shade System Iridium



109 CHF

Silver

8006304001

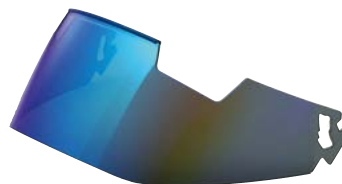

109 CHF

Blue

8006304002

Spare parts



TOUR-X5 VAS-A MAX-V shield



104 CHF

Clear	8008935001
Light smoked	8008935002
Dark smoked	8008935003

TOUR-X5 VAS-A mirror shield



204 CHF

Silver 8009200001

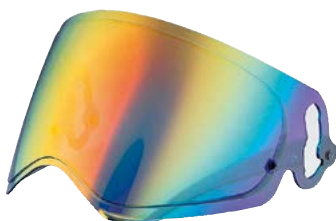

204 CHF

Red 8009200002



204 CHF

Blue 8009200003

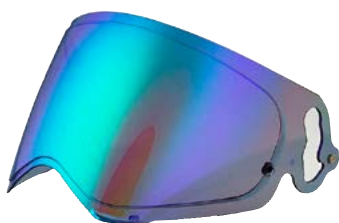

204 CHF

Green 8009200004

VAS-Z I Shield



104 CHF

Clear 8009215001



104 CHF

Light smoked 8009215002



104 CHF

Dark Smoked 8009215003

Spare parts



VAS-Z I mirror shield



214 CHF

Silver

8009214001

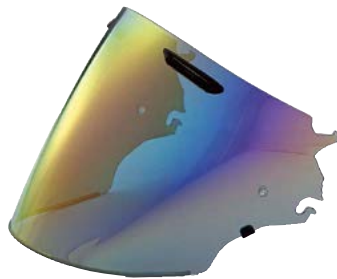

214 CHF

Red

8009214002



214 CHF

Blue

8009214003



214 CHF

Green

8009214004

SZ-R VAS-Z Shield



79 CHF

Clear

8003120001



79 CHF

Half Smoked

8003120002



79 CHF

Dark Smoked

8003120003

Spare parts



SZ-R VAS-Z Shield iridium



139 CHF

Silver Half Smoked

8003121001

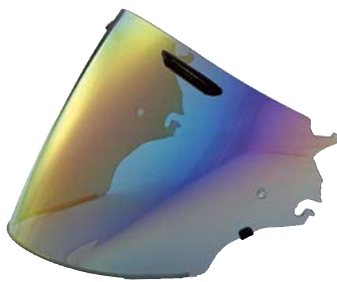

139 CHF

Red Half Smoked

8003121002



139 CHF

Blue Half Smoked

8003121003



139 CHF

Green Half Smoked

8003121004

PSS Ready Shield



79 CHF

Clear

8003099001

PSS Sun Visor



49 CHF

Smoked

8003100001

Spare parts



PSS Sun Visor Iridium



129 CHF

Silver

8003101001

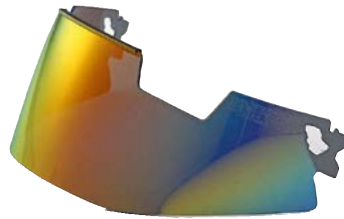

139 CHF

Red

8003101002



129 CHF

Blue

8003101003

TOUR-X4 - Shield TX-4 with Pinlock



79 CHF

Clear Brow Vents

8003115001



79 CHF

Dark Smoke Brow Vents

8003115002



79 CHF

Light Smoke Brow Vents

8003115003

SAI shield



79 CHF

Clear

8003103001



79 CHF

Dark smoked

8003103002



79 CHF

Clear smoked

8003103003

Spare parts



Shield SAI Dual



149 CHF

Clear

8003104001



149 CHF

Light smoke

8003104002

SAI Shield Mirrorized



119 CHF

Gold

8003105001



119 CHF

Silver

8003105002



119 CHF

Blue

8003105003



119 CHF

Purple

8003105004

Spare parts



SAI-2D LRS Shield



85 CHF

Clear

8003106001



85 CHF

Smoke

8003106002



85 CHF

Light Smoke

8003106003

SUP ADS MAXIVISION shield



89 CHF

Clear

8003107001

PRO Shade System



139 CHF

Sunvisor & Shield

8003089001

Shield SAI PSS



89 CHF

Clear

8006301002



59 CHF

Sunvisor Smoke

8006301001



55 CHF

Sunvisor XL Dark Smoke

8006302001

Spare parts



Super AdSis PRO Shade sunvisor mirror



125 CHF

Silver 8003093001

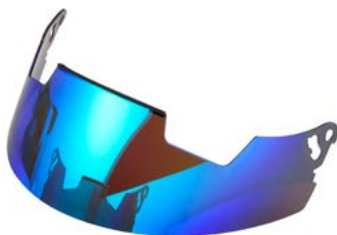

125 CHF

Blue 8003093002

SAL shield



79 CHF

Clear 8003108001



79 CHF

Dark Smoke 8003108002



79 CHF

Light Smoke 8003108003



79 CHF

Pinlock Amber 8003108004



79 CHF

Pinlock Blue 8003108005

■ Spare parts



Shield SUP ADS BV mirror

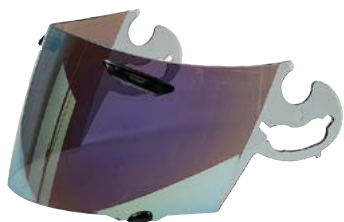

119 CHF

Gold

8003109001



119 CHF

Silver

8003109002



119 CHF

Blue

8003109003



119 CHF

Purple

8003109004

SAL 2D Shield



85 CHF

Clear

8003090001



85 CHF

Dark Smoke

8003090002



85 CHF

Light Smoke

8003090003

CT-M Shield pin



79 CHF

Clear

8003079001



79 CHF

Dark Smoke

8003079002



79 CHF

Light Smoke

8003079003

Spare parts



Super AdSis ZM Visor



79 CHF

Clear 8003110001



79 CHF

Deep Smoked 8003110002



79 CHF

Clear Smoked Visor 8003110003

Super AdSis ZM Visor Mirror



135 CHF

Silver 8003111001

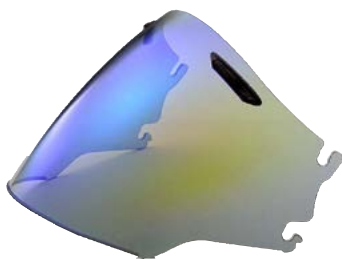

135 CHF

Blue 8003111002



79 CHF

Clear 8003122001



Spare parts



SZ Shield Iridium



135 CHF

Silver

8003124001



135 CHF

Blue

8003124002

Super Adsis shield



79 CHF

Dark Smoke

8003092001



69 CHF

Light Smoke

8003092002

© LIONEL BEYNOT

Suggested retail prices, all taxes included - updated online on

mybihr.com

■ Anti-fog lens



PINLOCK®

Pinlock offers a fantastic solution against shield fogging. Fogging can easily occur because of the difference in temperature inside and outside your helmet and your moist breath.

- Pinlock Original insert is made of a moisture absorbing plastic : surface basically dry when used
- Pinlock insert has a silicone seal : creates a double shield system
- Air-tight pocket ensures that the difference in temperature becomes significantly lowered
- Pinlock insert absorbs moisture on the inside and offers you continuous clear visibility

LENS COLOR

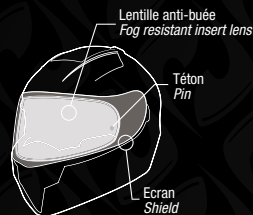

CLEAR

This insert offers you clear and fog free vision under normal weather conditions

LENS COLOR

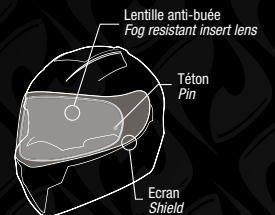

LIGHT SMOKE

This lightly tinted insert offers you comfortable vision under partially cloudy skies conditions

MAX VISION

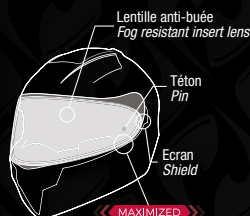

100% MAX VISION

- Maximum field of view
- The lens is fully integrated inside the shield
- No false light leakage

LENS COLOR

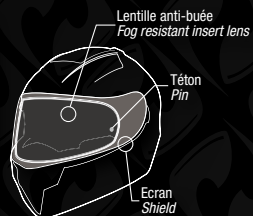

DARK SMOKE

This dark tinted insert provides excellent protection against the most brilliant of sunshine

PROTECTINT

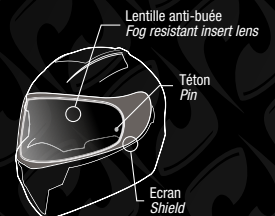

ProtectINT™

This photochromic insert tints under the effect of UV lights. As the UV light becomes stronger, the insert will tint darker.

Spare parts



Type	Ref.	
PINLOCK KIT 30 CLEAR	8007301	24 CHF
MAXVISION VAS		
PINLK VISOR ARAI MAXVISION VAS PROT, TTD	8004586001	75 CHF
PINLK VISOR ARAI MAXVISION VAS, CLR	8004585001	45 CHF
TOUR-X		
PINLK TOUR-X PROTECTINT	8000024	79 CHF
PINLK VISOR ARAI ORIGINAL TOUR-X, CLR	8004582001	42 CHF
PINLK ARAI SHIELD TYPE TOUR-X YELLOW	8005372	45 CHF
PINLK ARAI SHIELD TYPE TOUR-X LIGHT SMOK	8005401	45 CHF
PINLK ARAI SHIELD TYPE TOUR-X TINT	8006016	45 CHF
VAS-Z		
PINLK VAS-Z PROTECTINT	8000023	79 CHF
SZ-R VAS		
PINLK VISOR ARAI SZ-R VAS, CLR	8004580001	45 CHF
MAXVISION SAI		
PINLK PINLOCK MAXVISION SHIELD, PROTECTINT	8006635001	66 CHF
PINLK VISOR ARAI MAXVISION SAI, CLR	8004584001	45 CHF
PINLK VISOR ARAI MAXVISION SAI, DSM	8004584002	45 CHF
PINLK VISOR ARAI MAXVISION SAI, LSM	8004584003	45 CHF
PINLK VISOR ARAI ORIGINAL SAI, CLR	8004660001	36 CHF
PINLK VISOR ARAI ORIGINAL SA, LSM	8004583001	36 CHF
PINLK VISOR ARAI ORIGINAL SAI, DSM	8004660002	36 CHF
SAL		
PINLK VISOR ARAI ORIGINAL SAL PROTECTINT	8002307	66 CHF
PINLK VISOR ARAI ORIGINAL SAL, SMK	8004581001	39 CHF
PINLK VISOR ARAI ORIGINAL SAL, LSM	8004581002	39 CHF
PINLK VISOR ARAI ORIGINAL SAL, CLR	8004581003	39 CHF
CT-F		
PINLK CT-F PROTECTINT	8000022	79 CHF
PINLK VISOR ARAI ORIGINAL CT-F, CLR	8004626001	42 CHF
PINLK ARAI SHIELD TYPE CT-F YELLOW	8005348	45 CHF
PINLK ARAI SHIELD TYPE CT-F LIGHT SMOKE	8005349	45 CHF
PINLK ARAI SHIELD TYPE CT-F TINT	8005371	45 CHF

PINLOCK KIT 30



MAXVISION VAS



TOUR-X

SZ-R VAS



MAXVISION SAI



SAL

CT-F





© LIONEL BEYLOT

ACS 10



Exclusive Arai intercoms.

These products are suitable for the Arai Quantic, RX-7V and RX-7V EVO helmets.

BIHR is designated as the exclusive distributor of suitable SENA intercoms to Arai helmets.



ACS 10

SENA Intercoms for the Arai Quantic, RX-7V and RX-7V EVO helmets.

SENA Intercoms ACS10

800 7313



Product specification



HD speakers



Four-way intercom



HD Intercom



Intercom 1.6KM /1.0MI



Bluetooth 4.1



Smartphone app



Smart intercom pairing



Multi-language voice prompts



Advanced noise control™



Firmware upgradable



Exclusive Arai intercoms.

ACS-RAM is suitable for ARAI SZ-R VAS helmets.

BIHR is designated as the exclusive distributor of suitable SENA intercoms to Arai helmets.



ACS-RAM

SENA Intercoms ACS-RAM
for Arai SZ-R VAS helmets

SENA Intercoms ACS-RAM

800 7730

Product specification



Two-way intercom



HD Intercom



Intercom range
500m



Smartphone app



Smart intercom
pairing



Firmware upgradable



Multi-language voice
prompts



Custom helmet fit





BIHR ARAI 2024 - CH FR

